



STUDIO **1,2 BED**  
& **APARTMENTS**  
COMMERCIAL SPACES



**ESTATEX.COM**  
EXCLUSIVELY MARKETING BY

Upto **8%**  
Guaranteed  
Rental Income

## PRESENTED BY

# APEX GROUP

---

Being an advocate of transforming real estate into the most professional and credible business in Pakistan, Apex Group leaves no stone unturned to turn its vision into a beautiful reality. Having spent 19 years in the real estate sector, Apex Group successfully developed, marketed & delivered multiple projects in mega cities of Pakistan.

Apex Group always focused on a benchmark that real estate projects should be endowed with the idea of well-planned community-building rather than simply constructing the infrastructure and letting people live in it. The result of its commitment to vision is, Apex Group finds its name today among the top real estate developers in the country.

## WHY INVEST IN

# URBAN HEIGHTS?

---

- Prime Location - Near Safari Villas, Bahria Town, Lahore.
- High Investment Yield up to 8%.
- Ready for Possession Apartments & Commercial Spaces.
- Developed by one of the trusted real estate developers, Apex Group.
- Roof Top BBQ Area available for BBQ Parties.
- Safe & Secure Investment Option in Flexible Payment Plan.
- Commercial and Co-working Spaces on the Ground Floor & Basement.
- High-Speed Elevators Installed for members and their families.
- A Gated Community with 24/7 Surveillance by CCTV & Security Staff.
- Monthly Income on Full Payment.







# LOCATION

This most-demanding project is in the construction phase in Bahria Town Lahore, between the main gate & Safari Villas. Its direct access to Raiwind Road, Defence Road, and Lahore Ring Road make Urban Height's location appealing.

- 1** Min Drive From Bahria Hospital
- 1** Min Drive From Safari Villas
- 2** Min Drive From Jamia Mosque
- 2** Min Drive From Ring Road
- 3** Min Drive From Eiffel Tower

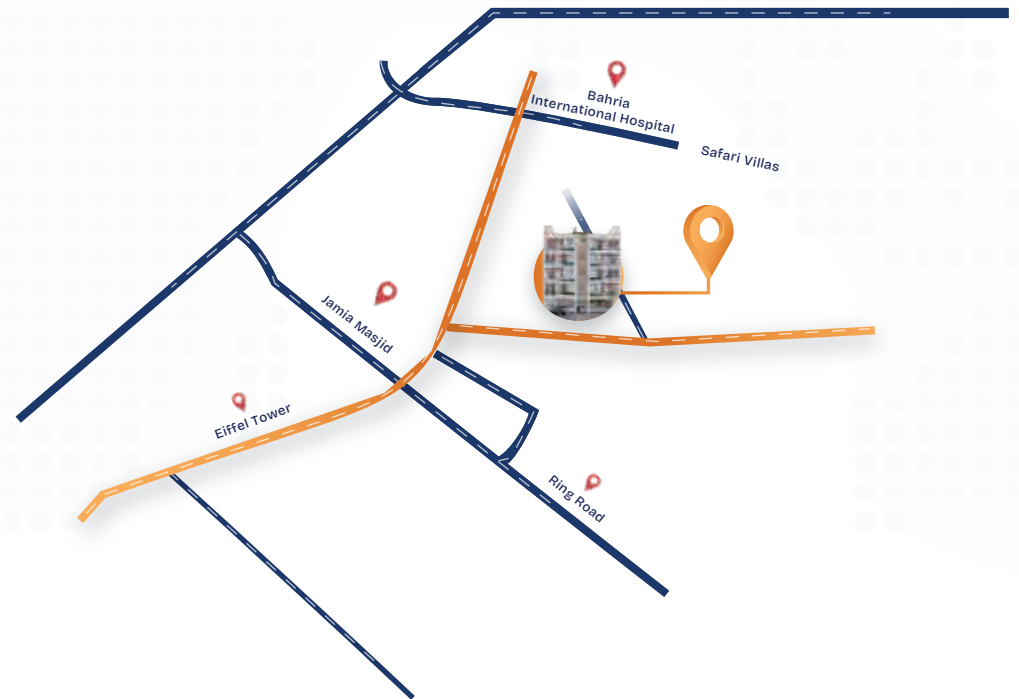

# FACILITIES & AMENITIES



Mosque



Roof Top  
Garden



Dedicated  
Parking



Gym



Bahria International  
Hospital



24/7 CCTV





# FLOOR PLANS

## COMMERCIAL

### BASEMENT FLOOR



TYPE	SHOP #	SIZE
Shop	BF-1	210
Shop	BF-2	210
Shop	BF-3	210
Shop	BF-4	210
Shop	BF-5	193
Shop	BF-6	193
Shop	BF-7	193
Shop	BF-8	193
Shop	BF-9	193
Shop	BF-10	193
Shop	BF-11	193
Shop	BF-12	193
Shop	BF-13	205
Shop	BF-14	205
Shop	BF-15	205

### GROUND FLOOR

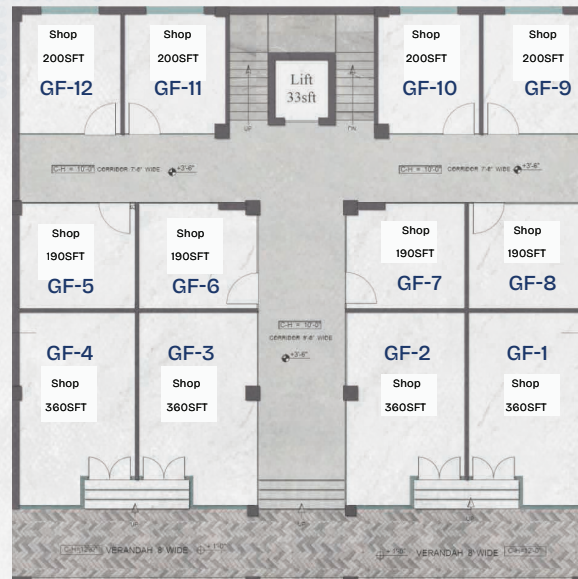

TYPE	SHOP#	SIZE
Shop	GF-1	360
Shop	GF-2	360
Shop	GF-3	360
Shop	GF-4	360
Shop	GF-5	190
Shop	GF-6	190
Shop	GF-7	190
Shop	GF-8	190
Shop	GF-9	200
Shop	GF-10	200
Shop	GF-11	200
Shop	GF-12	200

# APARTMENTS

## FIRST FLOOR



TYPE	APARTMENT #	SIZE
1 BED	FF-1	509
1 BED	FF-2	691
1 BED	FF-3	600
1 BED	FF-4	600
1 BED	FF-5	691
1 BED	FF-6	509

## SECOND FLOOR



TYPE	APARTMENT #	SIZE
1 BED	SF-1	509
1 BED	SF-2	691
1 BED	SF-3	600
1 BED	SF-4	600
1 BED	SF-5	691
1 BED	SF-6	509



# APARTMENTS

## THIRD FLOOR



TYPE	APARTMENT #	SIZE
STUDIO	TF-1	256
STUDIO	TF-2	302
1 BED	TF-3	597
1 BED	TF-4	577
1 BED	TF-5	635
2 BED	TF-6	901
STUDIO	TF-7	261

## FOURTH FLOOR



TYPE	APARTMENT #	SIZE
STUDIO	FF-7	256
STUDIO	FF-8	302
1 BED	FF-9	597
1 BED	FF-10	577
1 BED	FF-11	635
2 BED	FF-12	901
STUDIO	FF-13	261

# PAYMENT PLAN

	SIZE (sqft)	BOOKING	CONFIRMATION	POSSESSION	24* MONTHLY INSTALLMENTS	4* BI-ANNUAL INSTALLMENTS	TOTAL PRICE
1ST & 2ND FLOOR	509 1 Bed	839,850	1,259,775	2,099,611	69,988	629,888	8,398,500
	600 1 Bed	990,000	1,485,000	2,475,000	82,500	742,500	9,900,000
	691 1 Bed	1,105,600	1,658,408	2,764,000	92,133	829,200	11,056,000
3RD & 4TH FLOOR	256 Studio	435,200	652,792	1,088,000	36,267	326,400	4,352,000
	261 Studio	443,700	665,550	1,109,250	36,975	332,775	4,437,000
	302 Studio	513,400	770,108	1,283,500	42,783	385,050	5,134,000
	577 1 Bed	980,900	1,471,342	2,452,250	81,742	735,675	9,809,000
	597 1 Bed	1,014,900	1,522,358	2,537,250	84,575	761,175	10,149,000
	635 1 Bed	1,079,500	1,619,250	2,698,750	89,958	809,625	10,795,000
	901 2 Bed	1,531,700	2,297,542	3,829,250	127,642	1,148,775	15,317,000



	SIZE (sqft)	BOOKING	CONFIRMATION	POSSESSION	24* MONTHLY INSTALLMENTS	4* BI-ANNUAL INSTALLMENTS	TOTAL PRICE
GROUND FLOOR SHOP	190	589,000	883,500	1,472,500	49,083	441,750	5,890,000
	200	620,000	930,000	1,550,000	51,667	465,000	6,200,000
	360	1,296,000	1,944,000	3,240,000	108,000	972,000	12,960,000
LOWER GROUND FLOOR	193	366,700	550,050	916,750	30,558	275,025	3,667,000
	205	389,500	584,250	973,750	32,458	292,125	3,895,000
	210	399,000	598,500	997,500	33,250	299,250	3,990,000

#### Terms and Conditions:

Area may vary at the time of Possession.

Prices are subject to change without any prior notice.

The actual measurement of apartments will be done after completion & prices will be adjusted accordingly.

10% amount will be added on premium factor.

All prices are in PKR.

EXCLUSIVELY MARKETING BY  
**ESTATEX.COM**



BROUGHT  
TO YOU BY



**FOR MORE INFORMATION & BOOKING**  
CALL OR VISIT US TODAY

📍 **1st Floor, IEP Building,  
Liberty Chowk Gulberg 3 Lahore.**

📞 **042 111 300 600**

**[www.estatex.com](http://www.estatex.com)**